

# EasyRestore

Fiber Shear for Traffic Cabinets



## Overview

EtherWAN's EasyRestore for Fiber is a cabinet termination device for traffic cabinets and roadside nodes. EasyRestore allows fiber optic cabling to be control sheared at the base of the cabinet, preventing stress on the cable in the ground and at the electrical device connection.

EtherWAN — "When Connectivity is Crucial."

## Highlights

### + Time/Cost Saving Features

- Infrastructure fiber cabling remains intact after an accident knocks down a cabinet
- Enables device restoration within minutes of equipment reset
- Eliminates patch cords and additional failure points, reducing maintenance costs

### + Outdoor Rated Design

- Maintains material integrity at a wide operating temperature range from -40 to 180°F
- IP66 weather resistance
- Outdoor rated cabling

### + Support

- Complimentary technical support
- Free firmware upgrades and notifications
- Limited lifetime warranty

## Specifications

### + Physical

**Casing Material**

Delrin

**IP Rating**

IP66

**Dimensions**

10.5" x 5" x 1.2" (W x D x H)

**Weight**

2lbs (0.91kg)

**Module Coupling Retainer Screws**

#8 Zinc Plated Machine Screws

**Cabinet Channel Mounting Screws**

1/4-20 threaded Electro-galvanized steel, Unistrut model P6013-1420, with 1/2" extended 1/4-20 machine screws

**Pad Mount**

Steel Read Head Drop-in Anchors

**Fiber**

G.652.D glass, in tight buffered I/O jacketed configuration

**Fan Out**

4.5ft I/O fan-out to 36in long 3.0mm fiber, Total 7.5ft of interconnect cable inside cabinet

**Fan Out Cable**

Outdoor hazardous duty cable tight buffered, 1.5M-BIF, 3.0mm, yellow polyurethane jacket

**Configuration**

Device with drop cable and 3.0mm outdoor-rated interface cable

**Number of Connectors**

12 total

**Connector Type**

LC

**Mounting**

Concrete pedestal mount or cabinet wall mount

### + Environmental

**Operating Temp.**

-40 to 180°F (-40 to 75°C)

**Storage Temp.**

-40 to 185°F (-40 to 85°C)

**Relative Humidity**

5% to 95% (non-condensing)

### + Warranty

**Length**

Limited Lifetime

**Details**

[www.etherwan.com/support/warranty-policy](http://www.etherwan.com/support/warranty-policy)

### + What's Included

**Device**

Injector

**Installation**

Mounting brackets, screws, 4-pin terminal block

**Documentation**

Quick install guide

## Dimensions

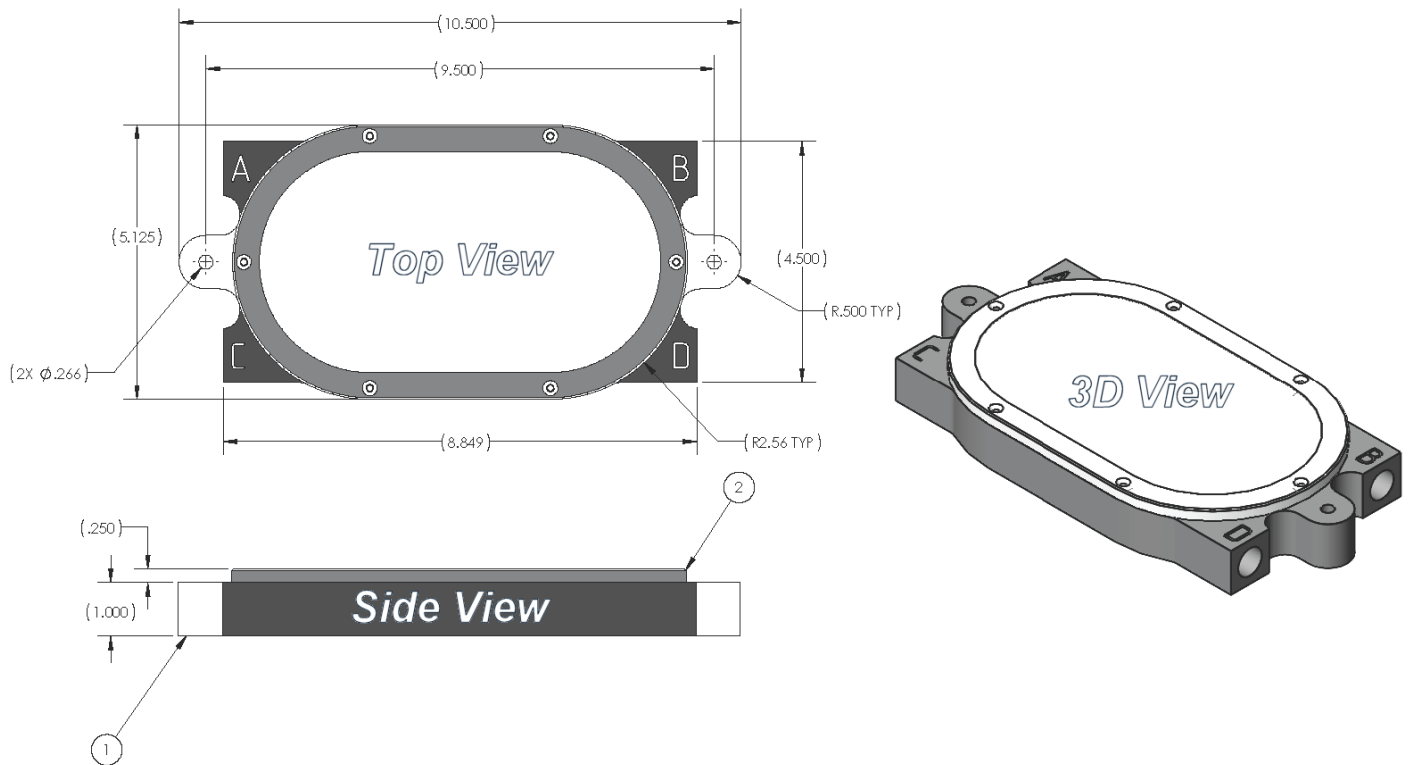

## Ordering Info

### + Model

<b>EASYRESTORE-LC-AB</b>	EasyRestore Device + 12 LC Connectors for Switches + Connector and Bulkhead for Infrastructure Side
<b>EASYRESTORE-LC</b>	EasyRestore Device + 12 LC Connectors for Switches, for Replacement Purpose

